

21 WEST VIEW PLACE, STRATHMORE, AB

MAIN - 1160.18 Sq.ft. / 107.78 m²

RMS TOTAL - 1160.18 Sq.ft. / 107.78 m²

BASEMENT - 1126.22 Sq.ft. / 104.63 m²

*FINISHED TOTAL - 1065.47 Sq.ft. / 98.98 m²

JOSEPH PURCELL
REAL ESTATE PROFESSIONALS INC.
403.612.5298
SMARTBUYCALGARY@GMAIL.COM
JANUARY 22, 2020

DETACHED SINGLE FAMILY

*RECA RMS MEASUREMENTS ARE TAKEN TO EXTERIOR FOUNDATION

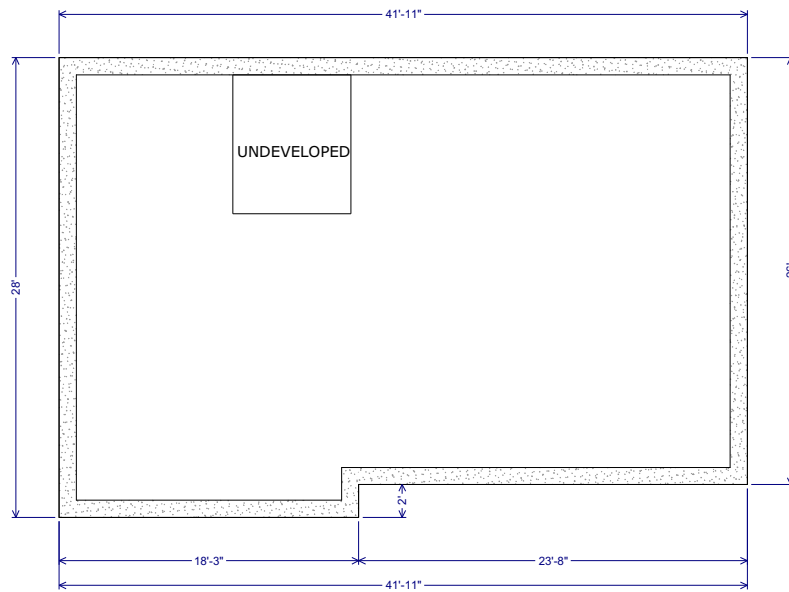

BASEMENT

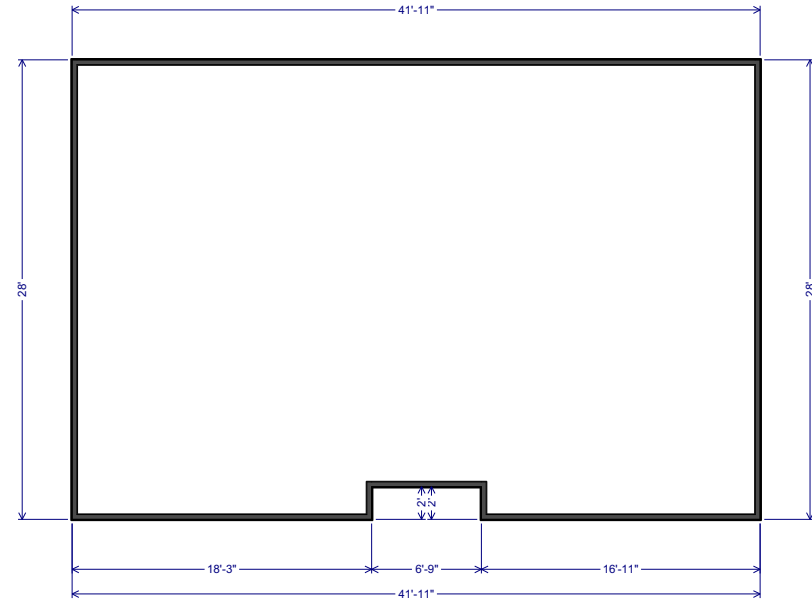

MAIN LEVEL